



WALLTITE®

The airtight insulation solution

Existing pitched roof insulation

Data sheet 2.2

 **BASF**

We create chemistry

Existing pitched roof insulation Data sheet 2.2

Description

WALLTITE can be applied directly onto the underside of existing slate or tiled roofs. It seals any air gaps, preventing the ingress of windblown snow, rain, dust and unwanted air infiltration.

The water vapour permeability of WALLTITE permits all roof timbers to dry out following periods of solar radiation.

WALLTITE is applied between rafters in sloping ceiling areas and loft conversions. Plasterboard can then be fixed to the rafters.

In applications such as barn conversions the foam is dubbed out with a coat of bonding plaster and then finish plaster. Existing structures must be in a good state of repair with no evidence of rain penetration or damp. Defects should be made good prior to installing the product. WALLTITE also reduces airborne noise pollution from air and road traffic.

Certification

BBA Certificate No. 11/4816.

WALLTITE has undergone various performance tests. Certificates are available on request.



Technical data

Specification:	Spray applied polyurethane foam between battens and rafters, directly onto existing tiles or slates
NBS clause:	P10 15A
Air leakage (50mm):	0.0033m ³ hm ²
Lambda 90/90:	0.025W/mK
Fire rating:	Class 1 to BS 476: Part 7
Water vapour diffusion resistance factor:	61.12
Adhesion to tiles	123kPa

U-values

Thickness of WALLTITE (mm)	U-value (W/m ² K)
190	0.14
160	0.16
140	0.18

Typical detail:

Existing roof with breathable underlay

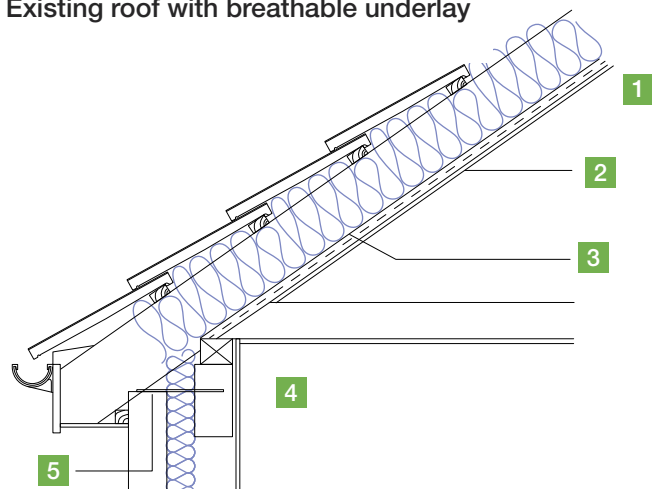

1. WALLTITE CL100 insulation to achieve target U-value
2. Plasterboard and skim (optional)
3. Unventilated air space
4. WALLTITE returned to insulated cavity stop at head of wall
5. Non-combustible cavity stop, well bedded and sealed

Habitable space: plasterboard and skim/VCL with taped joints (VCL to be carefully cut and sealed around struts, ceiling joists and penetrations); batten/counter batten rafters as necessary to achieve insulation depth, confirm rafter strength sufficient to receive counter battening and boarding if required.

Loft space only, non habitable: insulated between and over rafters to achieve target U-value. WALLTITE may remain exposed in a non-habitable loft space.

Repair all roof defects and thoroughly overhaul where necessary prior to spraying.

