



WALLTITE®

The airtight insulation solution

New pitched roof insulation

Data sheet 2.5

 **BASF**

We create chemistry

New pitched roof insulation Data sheet 2.5

Description

WALLTITE is applied directly to the 'over rafter' laminated insulation board, between timber rafters in tiled or slated pitched roofs.

This composite system of insulation provides all the benefits of reduced U-values, controlled air leakage and air infiltration and reduces thermal bridging to a minimum.

Certification

BBA Certificate No. 11/4816.

WALLTITE has undergone various performance tests. Certificates are available on request.



Technical data

Specification:	Spray applied polyurethane foam between rafters, directly onto board insulation
NBS clause:	P10 15A
Air leakage (50mm):	0.0033m ³ hrm ²
Lambda 90/90:	0.025 – 0.028W/mK
Fire rating:	Class 1 to BS 476: Part 7
Water vapour diffusion resistance factor:	61.12

U-values

Thickness of WALLTITE (mm)	Thickness of board (mm)	U-value (W/m ² K)
90	50	0.18
90	100	0.13

Typical detail:

New roof with board insulation

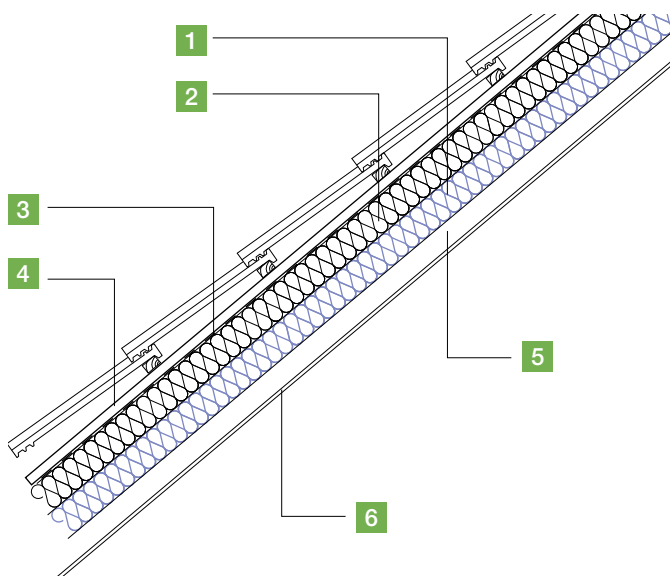

1. WALLTITE CL100 insulation between rafters to achieve target U-value
2. Over rafter PIR board insulation (minimum 50mm thick)
3. Breathable roof tile underlay
4. Counter-batten
5. Unventilated air space
6. Plasterboard and skim

Habitable space: plasterboard and skim/VCL with taped joints VCL to be carefully cut and sealed around struts, ceiling joists and penetrations); batten/counter batten rafters as necessary to achieve insulation depth, confirm rafter strength sufficient to receive counter battening and boarding if required.

Loft space only, non habitable: insulated between and over rafters to achieve target U-value. WALLTITE may remain exposed.



WALLTITE®