

## Typical detail:

### Room in a roof insulation

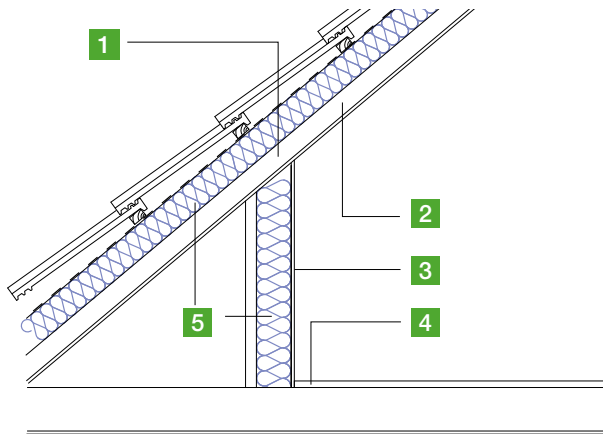

1. 100mm x 50mm rafter
2. Unventilated air space
3. Plasterboard and skim
4. Flooring
5. WALLTITE CL100 insulation to achieve target U-value

Habitable space: plasterboard and skim/VCL with taped joints VCL to be carefully cut and sealed around struts, ceiling joists and penetrations); batten/counter batten rafters as necessary to achieve insulation depth, confirm rafter strength sufficient to receive counter battening and boarding if required.

Loft space only, non habitable: insulated between and over rafters to achieve target U-value. WALLTITE may remain exposed.